

17PB41.

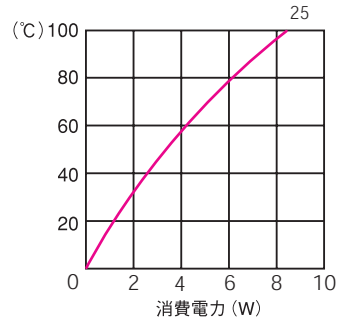
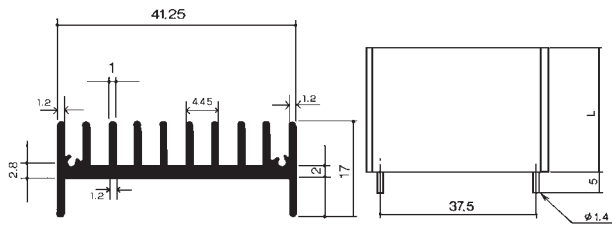

L	熱抵抗値 (°C/W)
25B	16.0
—	—
—	—

単重 1M=0.529kg

17PB47

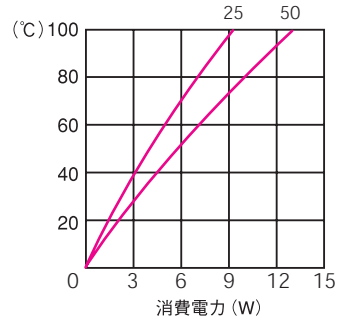
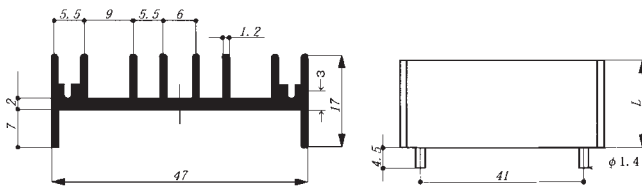

L	熱抵抗値 (°C/W)
25B	13.2
50B	8.3
—	—

単重 1M=0.524kg

20PB19

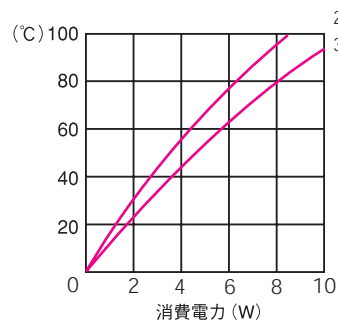
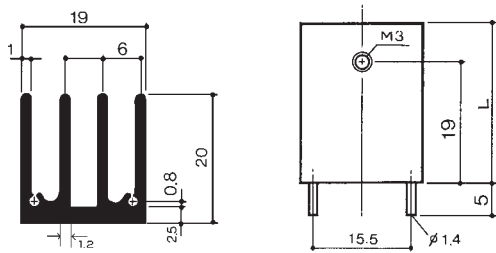

標準品=L25B
L30B

L	熱抵抗値 (°C/W)
25B	16.3
30B	14.9
—	—

単重 1M=0.351kg

20PB31

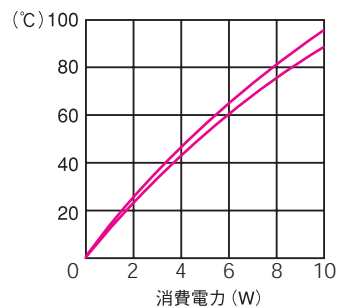
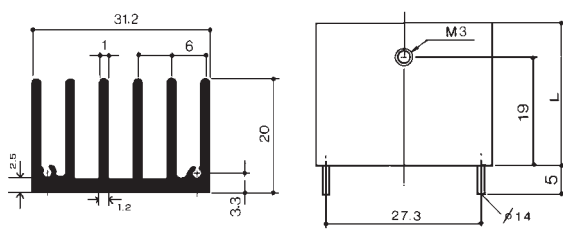

標準品=L25B
L30B

L	熱抵抗値 (°C/W)
25B	14.6
30B	13.0
—	—

単重 1M=0.543kg

20PB35

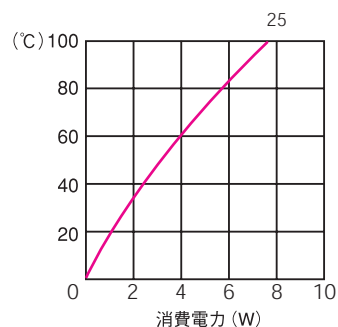
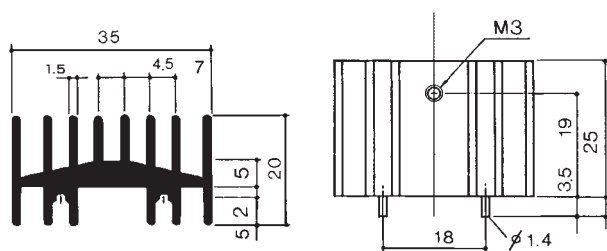

標準品=L25B

L	熱抵抗値 (°C/W)
25B	14.3
—	—
—	—

単重 1M=0.851kg