

# CE-FS シリーズ

105°C保証標準品



- 105°C 1,000~2,000時間
- 耐洗浄品 (2分間以内)

φ18×16.5

**NEW**

■仕様

| 項目             | 条件                         |                           | 特性   |      |      |      |      |      |      |          |  |
|----------------|----------------------------|---------------------------|--|------|------|------|------|------|------|----------|--|
| 定格電圧 (V)       | -                          |                           | 6.3  | 10   | 16   | 25   | 35   | 50   | 63   | 100      |  |
| サージ電圧 (V)      | 常温                         |                           | 8.0  | 13   | 20   | 32   | 44   | 63   | 79   | 125      |  |
| カテゴリ温度範囲 (°C)  | -                          |                           | -55 ~ +105                                 |      |      |      |      |      |      | -40~+105 |  |
| 定格静電容量許容差 (%)  | 120Hz/20°C                 |                           | M : ±20                                    |      |      |      |      |      |      |          |  |
| 損失角の正接 (tanδ)  | 120Hz/20°C                 | φ4~φ6.3                   | 0.24                                       | 0.20 | 0.16 | 0.14 | 0.12 | 0.10 | 0.12 | 0.10     |  |
|                |                            | φ8~φ18                    | 0.28                                       | 0.24 | 0.20 | 0.16 | 0.14 | 0.12 | 0.12 | 0.10     |  |
| 漏れ電流 (LC)      | μA以下/2分後                   |                           | 0.01CVまたは3のいずれか大きい値                        |      |      |      |      |      |      |          |  |
| 低温におけるインピーダンス比 | 120Hz、+20°Cを基準とする          | -40°C Z/Z <sub>20°C</sub> | 3  | 3    | 2    | 2    | 2    | 2    | 2    | 3        |  |
|                |                            | -55°C Z/Z <sub>20°C</sub> | 8  | 5    | 4    | 3    | 3    | 3    | 3    | -        |  |
| 耐久性            | 105°C<br>定格電圧印加<br>(リプル重畳) | 試験                        | φ4 ~ φ6.3:φ10×7.7:1,000時間、φ8 ~ φ18:2,000時間 |      |      |      |      |      |      |          |  |
|                |                            | ΔC/C                      | 初期値の±25%以内                                 |      |      |      |      |      |      |          |  |
|                |                            | tanδ                      | 初期規格値の2倍以下                                 |      |      |      |      |      |      |          |  |
|                |                            | LC                        | 初期規格値以下                                    |      |      |      |      |      |      |          |  |

■表示・形状・寸法

< φD ≤ 10 の表示 >

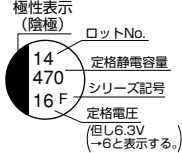

< φD ≥ 12.5 の表示 >

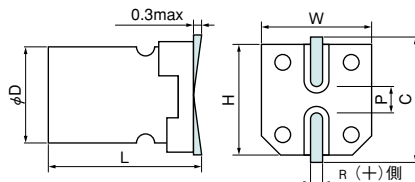
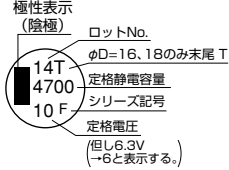

φD=8以上の製品には圧力弁がついています。

(単位:mm)

| D <sup>+0.5max</sup> | L                                   | W <sup>±0.2</sup> | H <sup>±0.2</sup> | C <sup>±0.2</sup> | R       | P <sup>±0.2</sup> |
|----------------------|-------------------------------------|-------------------|-------------------|-------------------|---------|-------------------|
| 4                    | 5.4 <sup>+0.1</sup> <sub>-0.2</sub> | 4.3               | 4.3               | 5.0               | 0.5~0.8 | 1.0               |
| 4                    | 6.0 <sup>±0.3</sup>                 | 4.3               | 4.3               | 5.0               | 0.5~0.8 | 1.0               |
| 5                    | 5.4 <sup>+0.1</sup> <sub>-0.2</sub> | 5.3               | 5.3               | 6.0               | 0.5~0.8 | 1.4               |
| 6.3                  | 5.4 <sup>+0.1</sup> <sub>-0.2</sub> | 6.6               | 6.6               | 7.3               | 0.5~0.8 | 2.2               |
| 6.3                  | 6.0 <sup>±0.3</sup>                 | 6.6               | 6.6               | 7.3               | 0.5~0.8 | 2.2               |
| 6.3                  | 7.7 <sup>±0.3</sup>                 | 6.6               | 6.6               | 7.3               | 0.5~0.8 | 2.2               |
| 8                    | 10.2 <sup>±0.3</sup>                | 8.3               | 8.3               | 9.0               | 0.7~1.0 | 3.2               |
| 10                   | 7.7 <sup>±0.3</sup>                 | 10.3              | 10.3              | 11.0              | 1.0~1.4 | 4.6               |
| 10                   | 10.2 <sup>±0.3</sup>                | 10.3              | 10.3              | 11.0              | 1.0~1.4 | 4.6               |
| 12.5                 | 13.5 <sup>±0.5</sup>                | 12.8              | 12.8              | 13.5              | 1.0~1.4 | 4.6               |
| 16                   | 16.5 <sup>±0.5</sup>                | 16.3              | 16.3              | 17.3              | 1.8~2.1 | 7.0               |
| 18                   | 16.5 <sup>±1.0</sup>                | 19.0              | 19.0              | 20.0              | 1.7~2.1 | 7.0               |

アルミ電解コンデンサ

CE-BJ

CE-BE

CE-BD

CE-BSS

CE-BS

CE-FE

CE-FD

CE-LD

CE-FSS

CE-FU

CE-FS

CE-FH

CE-GA

CE-AX

CE-KX

CE-LX

CE-LS

CE-LH

CE-LL

CE-PC

CE-PH

CE-NP

CE-FN

ME-SWB

ME-UZ・SZ

ME-UAX・SAX

ME-LS

ME-HC

ME-CZ

ME-CA

ME-CX

ME-AX

ME-WX

ME-WA

ME-WL

ME-SWG

ME-WG

ME-PX

ME-HPC・HPD

ME-FC・FD

ME-FAZ

ME-FH

ME-SWN

ME-HWN

- CE-BJ
- CE-BE
- CE-BD
- CE-BSS
- CE-BS
- CE-FE
- CE-FD
- CE-LD
- CE-FSS
- CE-FU
- CE-FS
- CE-FH
- CE-GA
- CE-AX
- CE-KX
- CE-LX
- CE-LS
- CE-LH
- CE-LL
- CE-PC
- CE-PH
- CE-NP
- CE-FN
- ME-SWB
- ME-UZ・SZ
- ME-UAX・SAX
- ME-LS
- ME-HC
- ME-CZ
- ME-CA
- ME-CX
- ME-AX
- ME-WX
- ME-WA
- ME-WL
- ME-SWG
- ME-WG
- ME-PX
- ME-HPC・HPD
- ME-FC・FD
- ME-FAZ
- ME-FH
- ME-SWN
- ME-HWN

■サイズリスト、定格リップル電流

| μF \ V | 6.3       |      | 10        |      | 16        |      | 25        |      | 35        |     |
|--------|-----------|------|-----------|------|-----------|------|-----------|------|-----------|-----|
| 4.7    |           |      |           |      |           |      | 4x5.4     | 13   | 4x5.4     | 14  |
| 10     |           |      |           |      | 4x5.4     | 18   | 5x5.4     | 20   | 5x5.4     | 21  |
| 22     | 4x5.4     | 22   | 5x5.4     | 25   | 5x5.4     | 27   | 6.3x5.4   | 36   | 6.3x5.4   | 38  |
| 33     | 5x5.4     | 27   | 5x5.4     | 30   | 6.3x5.4   | 40   | 6.3x5.4   | 44   | 6.3x6.0   | 42  |
| 47     | 5x5.4     | 33   | 6.3x5.4   | 41   | 6.3x5.4   | 48   | 6.3x6.0   | 48   | 6.3x6.0   | 49  |
| 100    | 6.3x5.4   | 50   | 6.3x5.4   | 53   | 6.3x5.4   | 60   | 6.3x7.7   | 91   | 6.3x7.7   | 84  |
| 150    |           |      | 6.3x6.0   | 62   | 6.3x7.7   | 95   | 8x10.2    | 140  | 8x10.2    | 155 |
| 220    | 6.3x6.0   | 67   | 6.3x7.7   | 105  | 6.3x7.7   | 105  | 8x10.2    | 175  | 8x10.2    | 190 |
| 330    | 6.3x7.7   | 105  | 8x10.2    | 195  | 8x10.2    | 195  | 8x10.2    | 220  | 10x10.2   | 300 |
| 470    | 8x10.2    | 210  | 8x10.2    | 210  | 8x10.2    | 230  | 10x10.2   | 300  | 12.5x13.5 | 410 |
| 680    | 8x10.2    | 210  | 10x7.7    | 210  | 10x10.2   | 310  |           |      | 12.5x13.5 | 430 |
| 1000   | 8x10.2    | 230  | 10x10.2   | 310  |           |      | 12.5x13.5 | 460  | 16x16.5   | 700 |
| 1500   | 10x10.2   | 310  |           |      | 12.5x13.5 | 500  |           |      | 16x16.5   | 740 |
| 2200   |           |      | 12.5x13.5 | 510  |           |      | 16x16.5   | 805  | 18x16.5   | 950 |
| 3300   | 12.5x13.5 | 520  |           |      | 16x16.5   | 840  | 18x16.5   | 1040 |           |     |
| 4700   |           |      | 16x16.5   | 880  | 18x16.5   | 1090 |           |      |           |     |
| 6800   | 16x16.5   | 930  | 18x16.5   | 1150 |           |      |           |      |           |     |
| 10000  | 18x16.5   | 1200 |           |      |           |      |           |      |           |     |

| μF \ V | 50        |     | 63        |     | 100       |     |
|--------|-----------|-----|-----------|-----|-----------|-----|
| 0.47   | 4x5.4     | 3.5 | 4x5.4     | 3.5 |           |     |
| 1.0    | 4x5.4     | 7.0 | 4x5.4     | 7.0 | 4x6.0     | 7.0 |
| 2.2    | 4x5.4     | 11  | 4x5.4     | 11  | 6.3x6.0   | 14  |
| 3.3    | 4x5.4     | 13  | 5x5.4     | 14  | 6.3x6.0   | 20  |
| 4.7    | 5x5.4     | 16  | 5x5.4     | 16  | 6.3x6.0   | 25  |
| 10     | 6.3x5.4   | 24  | 6.3x5.4   | 24  | 6.3x7.7   | 35  |
| 22     | 6.3x6.0   | 42  | 6.3x7.7   | 49  | 8x10.2    | 84  |
| 33     | 6.3x7.7   | 60  | 8x10.2    | 112 | 10x10.2   | 133 |
| 47     | 6.3x7.7   | 63  | 8x10.2    | 119 | 12.5x13.5 | 240 |
| 68     |           |     | 8x10.2    | 126 | 12.5x13.5 | 245 |
| 82     | 10x7.7    | 140 |           |     |           |     |
| 100    | 8x10.2    | 140 | 10x10.2   | 196 | 16x16.5   | 490 |
| 150    |           |     |           |     | 16x16.5   | 500 |
| 220    | 10x10.2   | 220 | 12.5x13.5 | 287 | 18x16.5   | 650 |
| 330    | 12.5x13.5 | 365 |           |     |           |     |
| 390    | 12.5x13.5 | 380 |           |     |           |     |
| 470    |           |     | 16x16.5   | 630 |           |     |
| 680    |           |     | 18x16.5   | 750 |           |     |
| 1000   | 16x16.5   | 655 |           |     |           |     |

リップル電流周波数補正係数はP.15をご参照ください。

ケースサイズ:φD×L(mm)  
10×7.7はCE-FSAシリーズ  
16×16.5、18×16.5はCE-FST

定格リップル電流  
mA<sub>rms</sub> (120Hz, 105°C)

■品番コード体系

